



Motorized pan/tilt/zoom control Color dome camera

YPZ-500-RS485 (PELCO-D
protocol)



**39-Camera multi-remote control by one remote, DVR,
computer, PELCO "D" protocol controller**

- Read this user's guide carefully before any installation for safety and operation of product.
- Features and specifications are subject to change without any notice for functional improvement

Remote controller operation

⑥ Focus control (Near, Far)

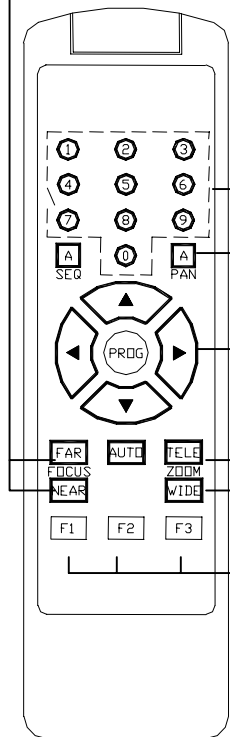

RC-100

① Camera selection

Use No.1 to No.9 to select settled address of the camera

② Auto Pan

On Auto Pan feature of selected camera

* Auto pan is stopped by press Left, right key.

* Auto Pan is automatically stopped after operating for 10 minutes.

③ Direction control key

Direction control key for selected camera

④ Extension of Address

F1 : UNIT 10

F2 : UNIT 20

F3 : UNIT 30

ex) Address 17 : F1 + No.7

⑤ Power zoom control key (TELE, WIDE)

1. Select ID No to match with desired camera's No. by press ① and push to program key

2. Working test by ③ ⑤ ⑥

Cable connection

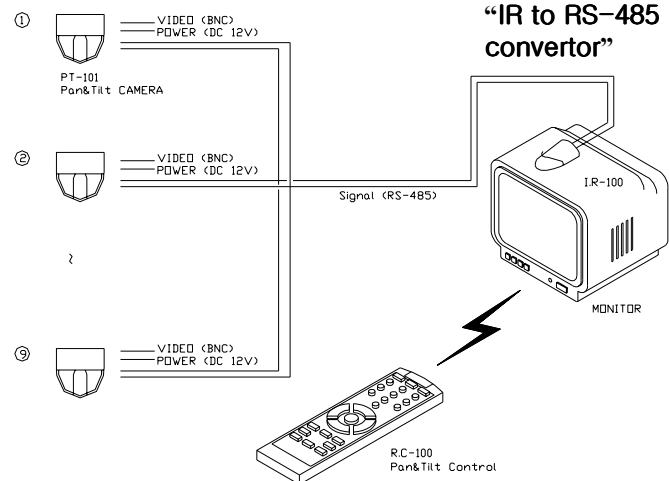

“Wireless remotecon”

“RS-485 BY PELCO-D PROTOCOL”

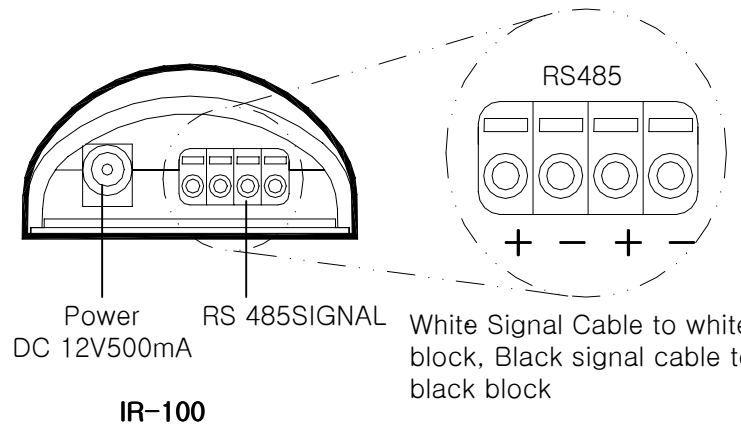

Power
DC 12V500mA

IR-100

White Signal Cable to white block, Black signal cable to black block

DIP S/W Establishment

- SW 1 to SW 8 is S/W to set up the address.
- SW 9 determine the beginning point of this model when it is reset and power supplied.
- SW10 is S/W to adjust impedance of control cable.
Please turn on the last Rx of S/W, as below picture.

Installation example

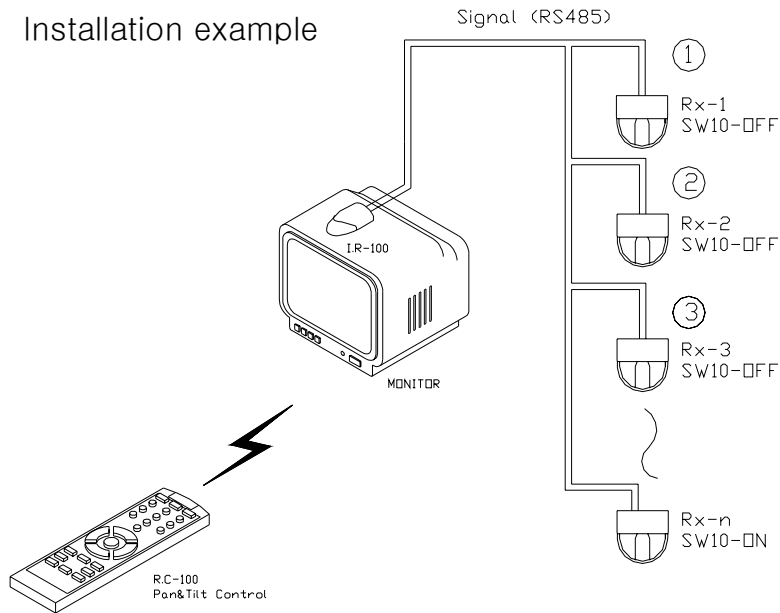

The last grade of camera SW No. 10 must be turned on.

DIP S/W

※S/W No.9 is option.

※ The last grade of Rx in S/W No.10 must be turned on.

Address	SW1	SW2	SW3	SW4	SW5	SW6	SW7	SW8
1	ON	OFF	OFF	OFF	OFF	OFF	OFF	OFF
2	OFF	ON	OFF	OFF	OFF	OFF	OFF	OFF
3	ON	ON	OFF	OFF	OFF	OFF	OFF	OFF
4	OFF	OFF	ON	OFF	OFF	OFF	OFF	OFF
5	ON	OFF	ON	OFF	OFF	OFF	OFF	OFF
6	OFF	ON	ON	OFF	OFF	OFF	OFF	OFF
7	ON	ON	ON	OFF	OFF	OFF	OFF	OFF
8	OFF	OFF	OFF	ON	OFF	OFF	OFF	OFF
9	ON	OFF	OFF	ON	OFF	OFF	OFF	OFF
10	OFF	ON	OFF	ON	OFF	OFF	OFF	OFF
11	ON	ON	OFF	ON	OFF	OFF	OFF	OFF
12	OFF	OFF	ON	ON	OFF	OFF	OFF	OFF
13	ON	OFF	ON	ON	OFF	OFF	OFF	OFF
14	OFF	ON	ON	ON	OFF	OFF	OFF	OFF
15	ON	ON	ON	ON	OFF	OFF	OFF	OFF
16	OFF	OFF	OFF	OFF	ON	OFF	OFF	OFF
17	ON	OFF	OFF	OFF	ON	OFF	OFF	OFF
18	OFF	ON	OFF	OFF	ON	OFF	OFF	OFF
19	ON	ON	OFF	OFF	ON	OFF	OFF	OFF
20	OFF	OFF	ON	OFF	ON	OFF	OFF	OFF
21	ON	OFF	ON	OFF	ON	OFF	OFF	OFF
22	OFF	ON	ON	OFF	ON	OFF	OFF	OFF
23	ON	ON	ON	OFF	ON	OFF	OFF	OFF
24	OFF	OFF	OFF	ON	ON	OFF	OFF	OFF
25	ON	OFF	OFF	ON	ON	OFF	OFF	OFF
26	OFF	ON	OFF	ON	ON	OFF	OFF	OFF
27	ON	ON	OFF	ON	ON	OFF	OFF	OFF
28	OFF	OFF	ON	ON	ON	OFF	OFF	OFF
29	ON	OFF	ON	ON	ON	OFF	OFF	OFF
30	OFF	ON	ON	ON	ON	OFF	OFF	OFF
31	ON	ON	ON	ON	ON	OFF	OFF	OFF
32	OFF	OFF	OFF	OFF	OFF	ON	OFF	OFF
33	ON	OFF	OFF	OFF	OFF	ON	OFF	OFF
34	OFF	ON	OFF	OFF	OFF	ON	OFF	OFF
35	ON	ON	OFF	OFF	OFF	ON	OFF	OFF
36	OFF	OFF	ON	OFF	OFF	ON	OFF	OFF
37	ON	OFF	ON	OFF	OFF	ON	OFF	OFF
38	OFF	ON	ON	OFF	OFF	ON	OFF	OFF
39	ON	ON	ON	OFF	OFF	ON	OFF	OFF